

Architectural elevation drawing of a building facade. The drawing shows a multi-story building with a series of windows. To the left of the building, three vertical dimension lines indicate heights: 16.50, 14.75, and 11.80. To the right of the building, four horizontal dashed lines with labels indicate levels: Liv 4, Liv 3, Liv 2, and Liv 1. The building facade features a grid of windows: the top two levels (Liv 4 and Liv 3) have large windows with dark frames and internal shading; the middle level (Liv 2) has smaller, simpler windows; and the bottom level (Liv 1) has large windows similar to the top levels. A small, dark, rectangular feature is visible on the roofline between the building and the Liv 4 level line.

NORD EST
1 : 100

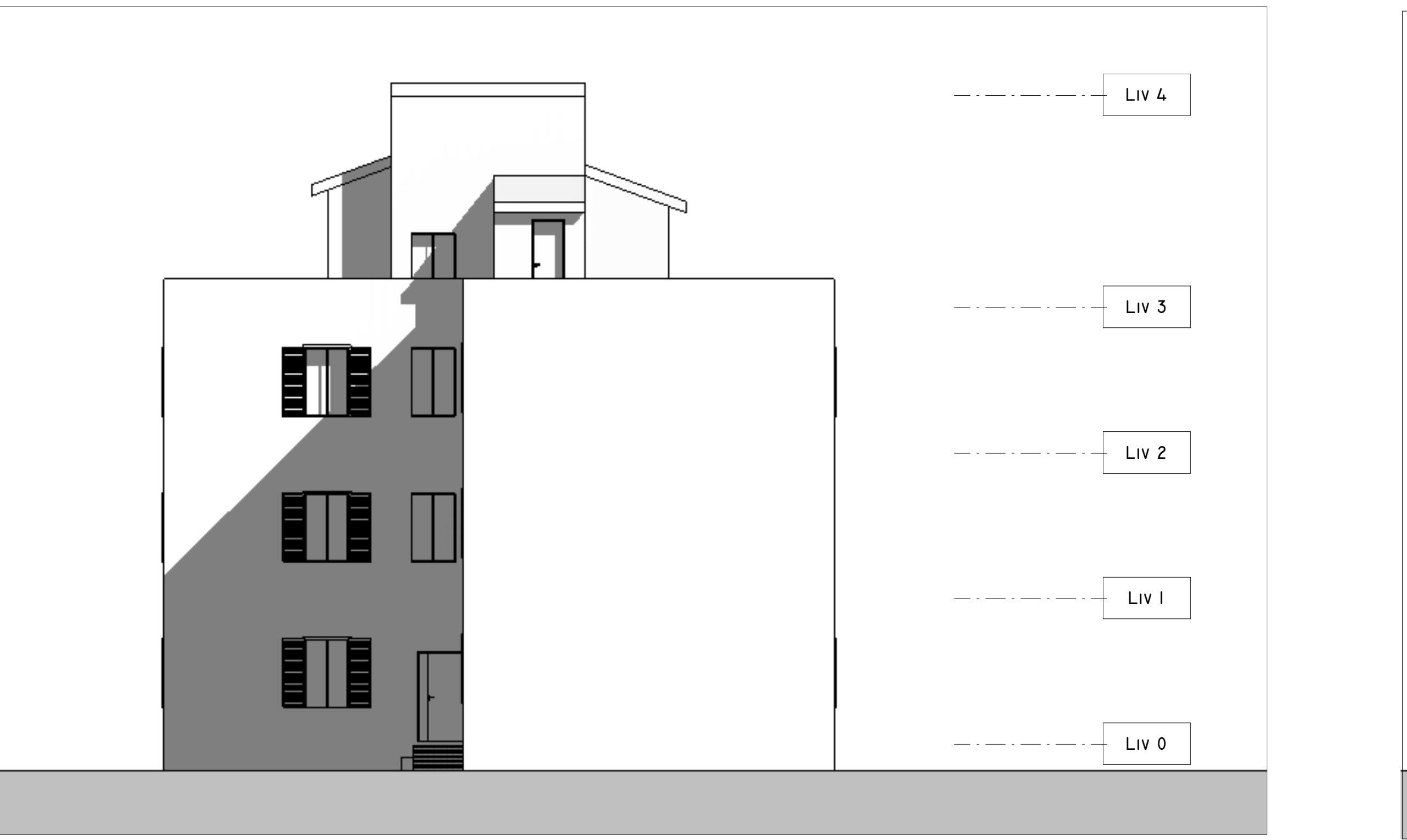

SUD EST
1 : 100

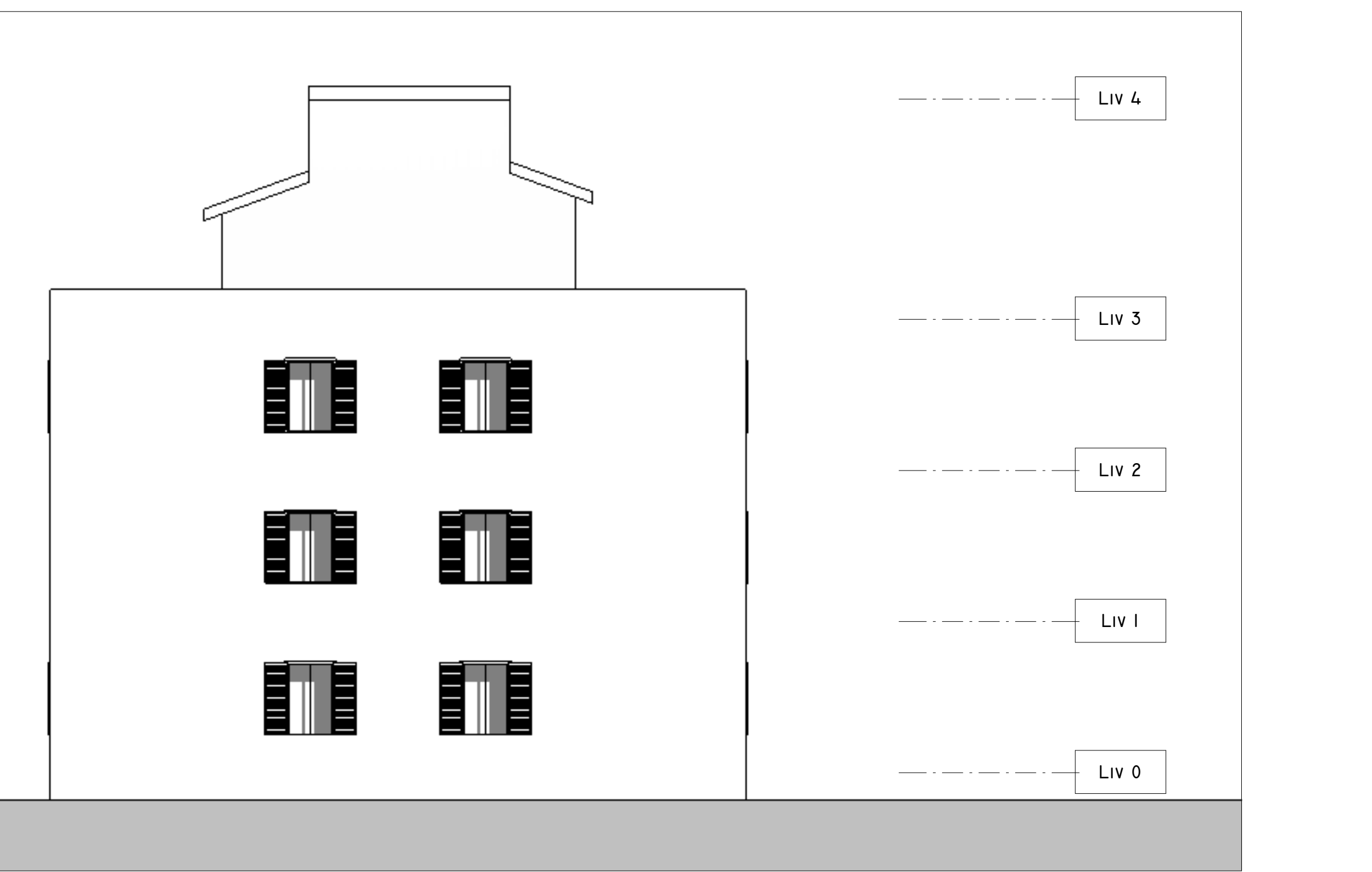

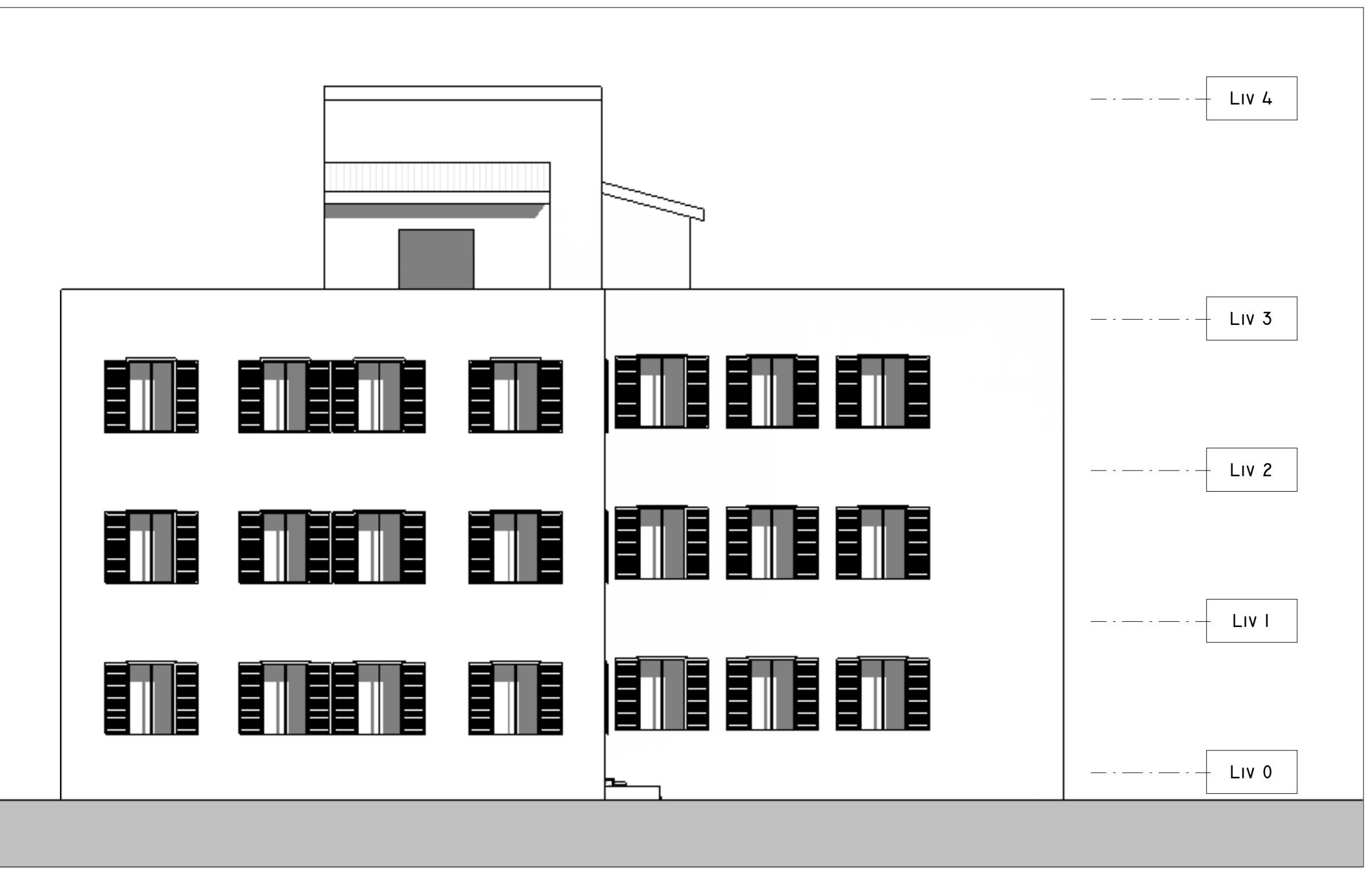

OVEST

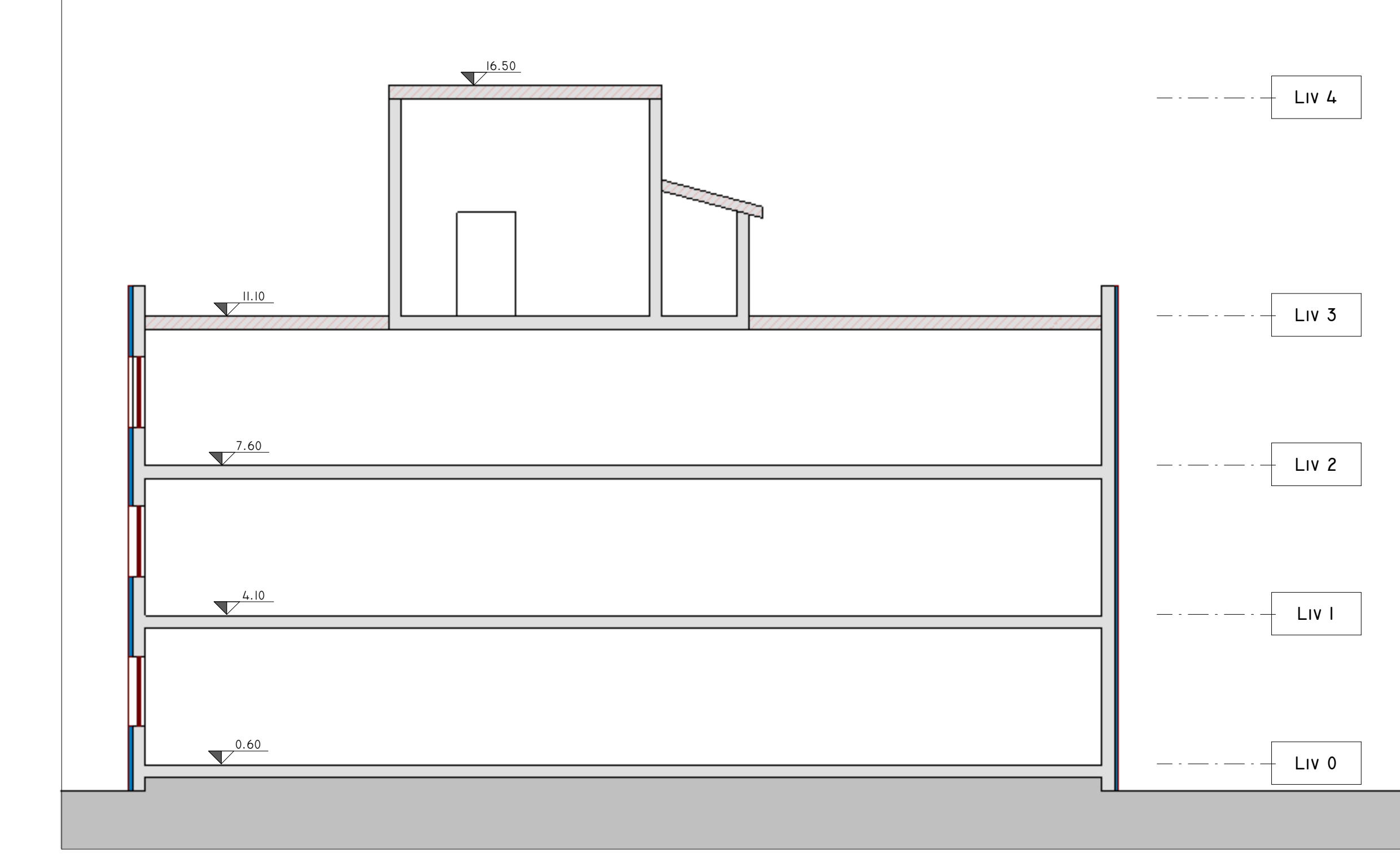

D OVEST
100



SEZION
I : 100

<u>INDIVIDUAZIONE INTERVENTI</u>			
CAPPOTTO SISMICO E TERMICO		CAPPOTTO TERMICO	
SOSTITUZIONE INFISSI E PERSIANE OVE PRESENTI		COIBENTAZIONE E RIFACIMENTO STRATI DI COPERTURA	